

# User Manual

## Guard Unit



### S Series Digital System Guard Unit

User Manual\_V1.0

Model No.: SIA01

# Attentions

1、 Please keep devices away from strong magnetic field , high temperature , wet environment ;



2、 Please do not fall the devices to the ground or make them get hard impact ;



3、 Please do not use wet cloth or volatile reagent to wipe the devices ;



4、 Please do not disassemble the devices.

# Contents

<b>Unit 1 Product Overview .....</b>	<b>3</b>
<b>Unit 2 Introduction .....</b>	<b>4</b>
2.1 Basic Structure .....	4
2.2 Interface description .....	5
2.3 Parameters .....	6
<b>Unit 3 Manual .....</b>	<b>7</b>
3.1 Basic Functions .....	7
3.2 Top Contacts .....	8
3.3 Contacts/Address Book .....	9
3.4 Call Out .....	10
3.5 Call Log .....	10
3.6 Contacts Setting .....	11
3.7 Surveillance List .....	13
3.8 Monitor Records .....	13
3.9 Monitor Setting .....	14
3.10 Card Management .....	15
<b>Chapter 4 System Settings .....</b>	<b>17</b>
4.1 Display Setting .....	17
4.2 Ringtone Setting .....	18
4.3 Time Setting .....	19
4.4 Language Setting .....	20
4.5 Call Forwarding .....	20
4.6 User Password Setting .....	21
4.7 About .....	21
4.8 Engineering Setting .....	23

# Unit 1 Product Overview

This product is based on TCP/IP protocol, works as a management center to manage the indoor monitors of residents and the outdoor stations of all the entrance of the community.

- **10.1 inch capacitive touch screen**
- **Can call indoor monitors and other guard units**
- **Can receive calls from indoor monitor, outdoor stations and other guard units**
- **Synchronously response to the alarming signal from the indoor monitor**
- **Record alarm information**
- **Remote unlock function, can unlock the outdoor stations/gate stations**
- **Monitor the Outdoor Stations, Gate Stations and IP Cameras**
- **Support emergency unlocking: unlock all outdoor stations with one key (1 hour)**

# Unit 2 Introduction

## 2.1 Basic Structure

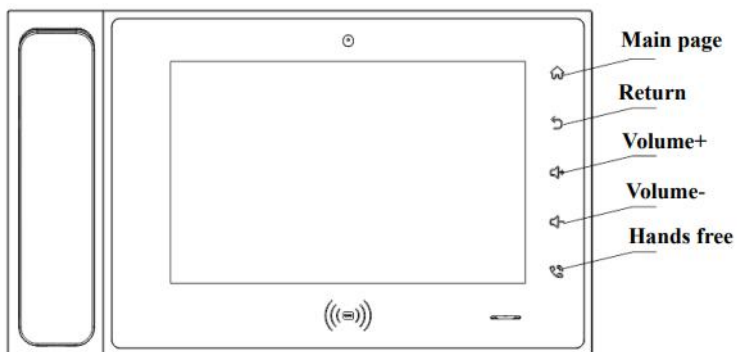

## 2.2 Interface description

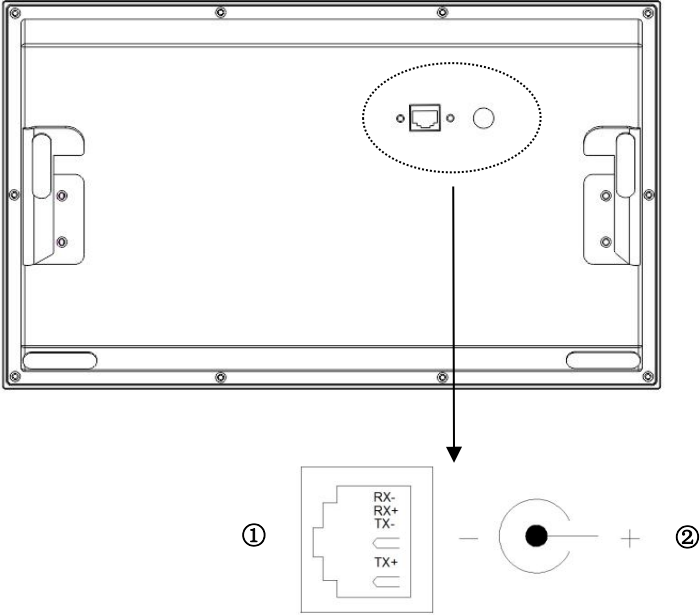

**No.①:** Connecting with LAN

**No.②:** DC 24V

## 2.3 Parameters

Working Voltage: DC 24V or 48V Standard PoE

Static Current:  $\leq 210$  mA

Working Current:  $\leq 400$  mA

Display: 10.1 inch

Resolution: 1280×800

Dimension(L\*W\*D): 210×356×31.8 mm (Not including handset and bracket)

Environment Temperature: -10℃ ~ +55℃

Ring Duration: 30s      Call Duration: 120s      Monitor Duration:30s

**Administrator password:** for emergency unlocking. The initial password is 666666.

**Engineering password:** for coding the number of the guard unit and factory reset. The password is 801801.

# Unit 3 Manual

## 3.1 Basic Functions

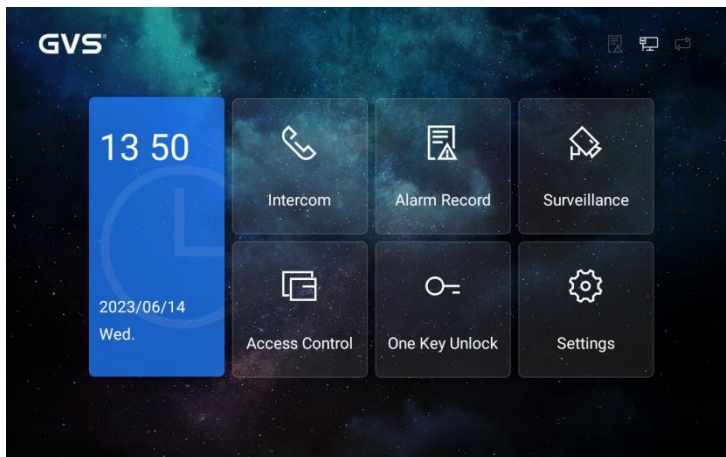

*Main Interface*

### Call and Talk

Click the icon  to view contacts, call history, dial to call and set up contacts.

### Call Log

Click the icon  to check all alarm records.

### Card Management

Click the icon  to register, delete, delete all, search and other operations for the user card.

### Monitor

Click the icon  to select devices to monitor in the monitoring list, view monitoring logs and make monitoring settings.



**One-Key unlock**

Click the icon  to unlock all locks with access control in case of emergency, such as fire, for a duration of 1 hour.

**Settings**

Click the icon  access the settings interface.

**3.2 Top Contacts**

Click on the intercom button and select the type of device to call.

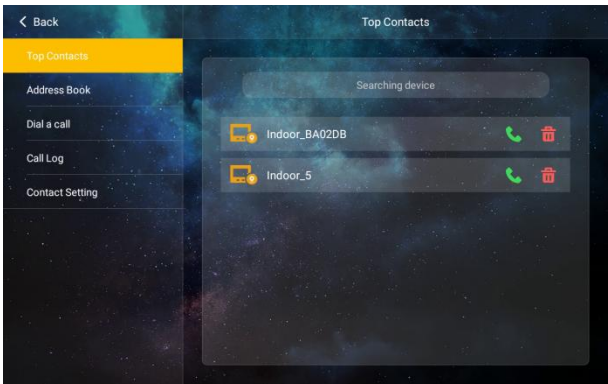

*Device selection interface*

In the contacts, tap to go to the details page of the corresponding contact and tap the X icon to add the contact to your frequently used contacts for a quick call.

### 3.3 Contacts/Address Book

The Address Book shows networked devices found with auto-configuration switched on, devices imported from the address book and devices added manually.

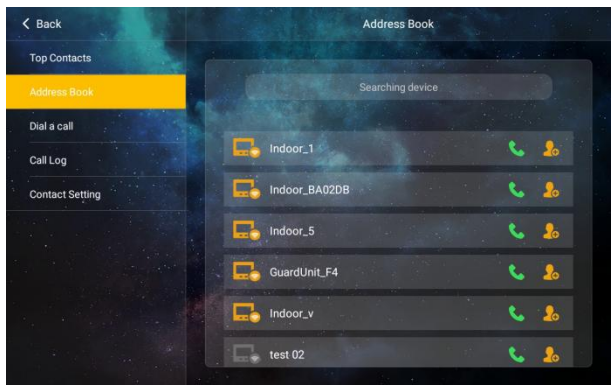

Call Log interface



Indicates the online devices on the same network discovered by the device;



Indicates a device on the same network that the device has been discovered, but is currently offline;



Indicates that the device issued by the address book and the device manually added by the user belong to the local device.

Click the icon  to add the current contact to frequent contacts;

### 3.4 Call Out

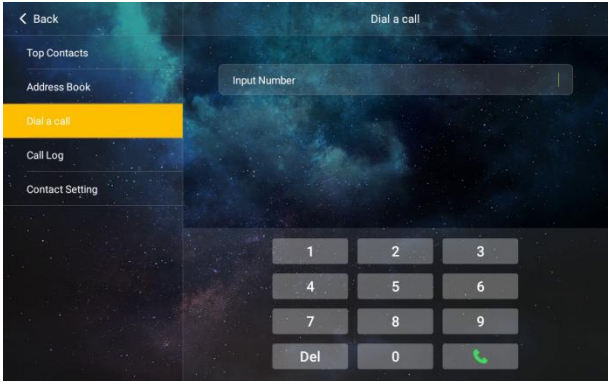

*Dial Call Interface*

Enter the user name of the SIP account corresponding to the device to call through to the device. For example, if the SIP account is "sip: 000100011@192.168.150.100:8060", enter "000100011" to call the device.

### 3.5 Call Log

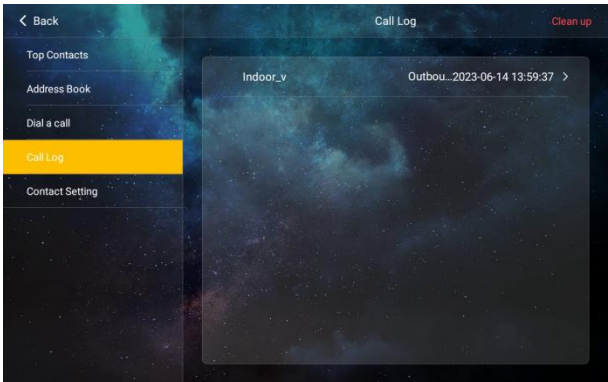

*Call Log Interface*

Call logs from other devices to this phone are displayed and unread calls are indicated by a red dot. Call records for which a photo has been captured have a photo icon.

# 3.6 Contacts Setting

Contacts or groups in the address book can be edited and added.

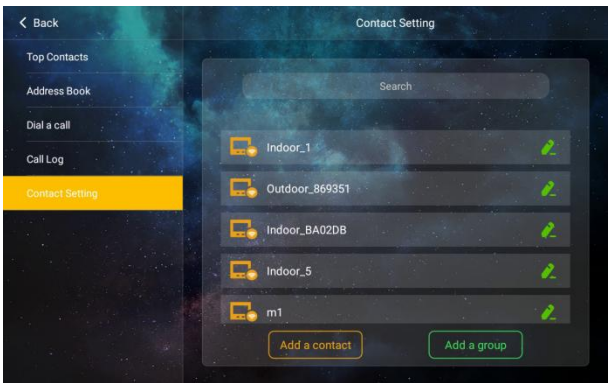

Contact Setting Interface

Contacts sent under Auto Discovery and Address Book can have their notes and DTMF passwords edited.

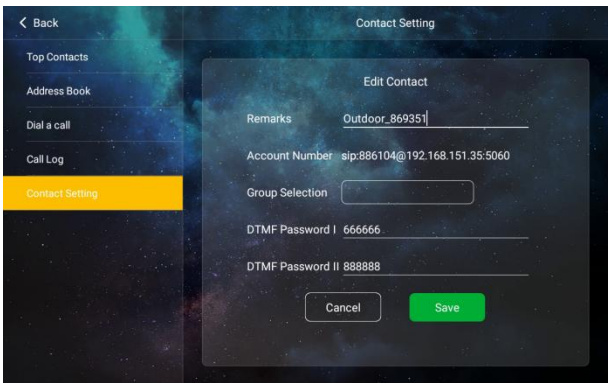

Edit contacts interface

To add a new contact you need to enter the contact notes, SIP account number, select the group to which you belong and select the ring tone for the call. (If the device has an access control function, you will also need to enter the DTMF unlock code for the device).

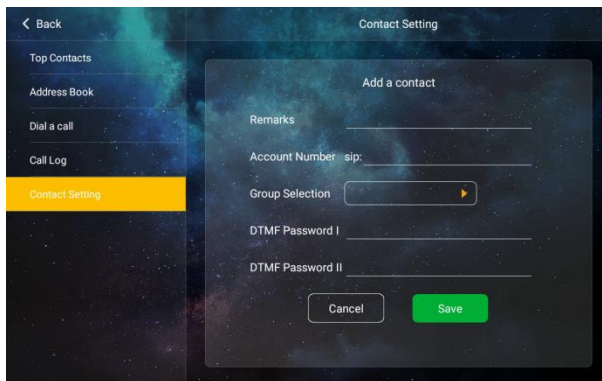

*Add contact interface*

To add a group you need to enter the group name and select the affiliated group to which you belong (if not selected, a level 1 group is created).

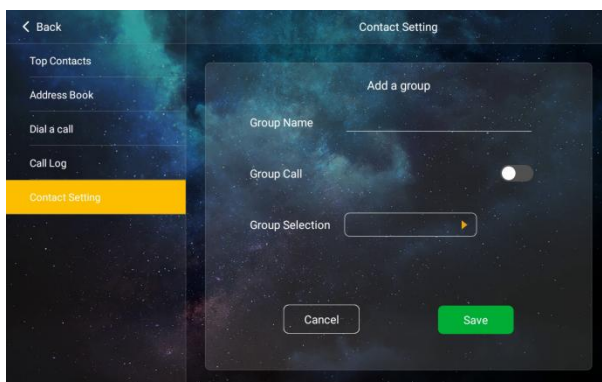

*Add group interface*

Only manually added devices and groups, as well as devices found in auto-configuration mode (offline state) can be deleted

### 3.7 Surveillance List

All online devices in the list can be monitored.

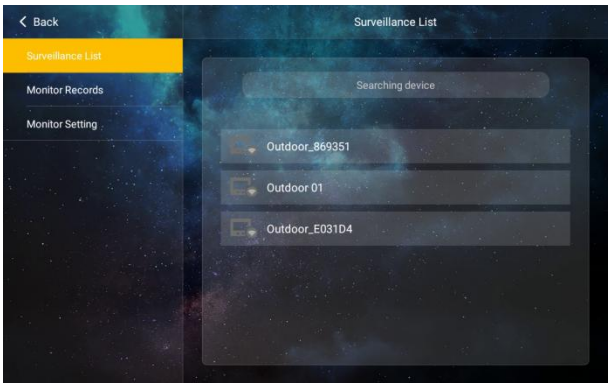

Add group interface

### 3.8 Monitor Records

A surveillance record is created by capturing a photo in the surveillance.

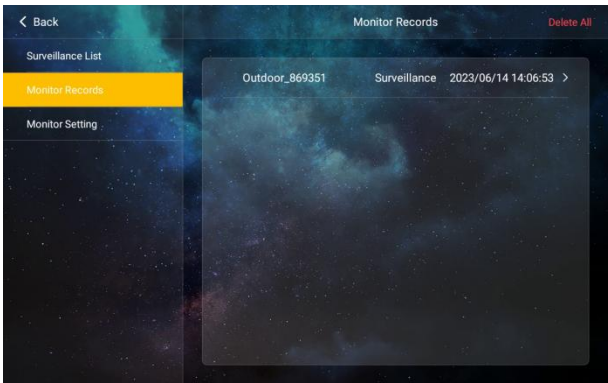

Add group interface

## 3.9 Monitor Setting

Monitor settings to view all monitored URLs.

Add monitor: just enter the device name, URL address and select the affiliated group to which it belongs.

Adding a group: enter a group name and select the affiliated group to create a group.

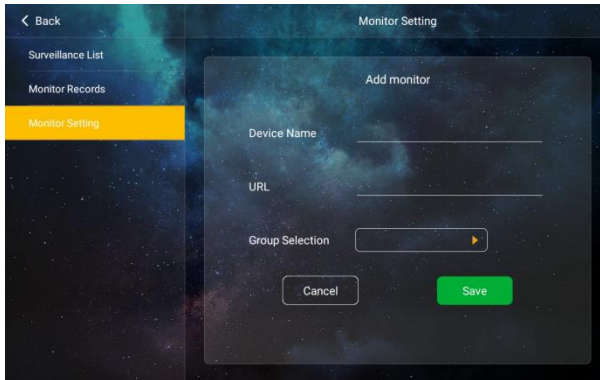

The screenshot shows the 'Monitor Setting' screen with a sidebar menu on the left containing 'Surveillance List', 'Monitor Records', and 'Monitor Setting' (highlighted in yellow). The main content area is titled 'Monitor Setting' and contains a modal window titled 'Add monitor'. Inside the modal, there are three input fields: 'Device Name', 'URL', and 'Group Selection' (which is a dropdown menu with a right-pointing arrow). At the bottom of the modal are two buttons: 'Cancel' and 'Save'.

*Add a monitor interface*

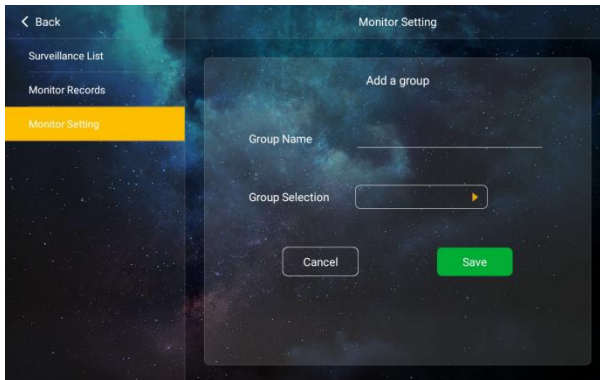

The screenshot shows the 'Monitor Setting' screen with the same sidebar menu. The main content area contains a modal window titled 'Add a group'. Inside the modal, there are two input fields: 'Group Name' and 'Group Selection' (a dropdown menu with a right-pointing arrow). At the bottom of the modal are two buttons: 'Cancel' and 'Save'.

*Add a group interface*

### 3.10 Card Management

Select the required operations on the left: register, check, delete, and clear up, and select the device to be operated on the right.

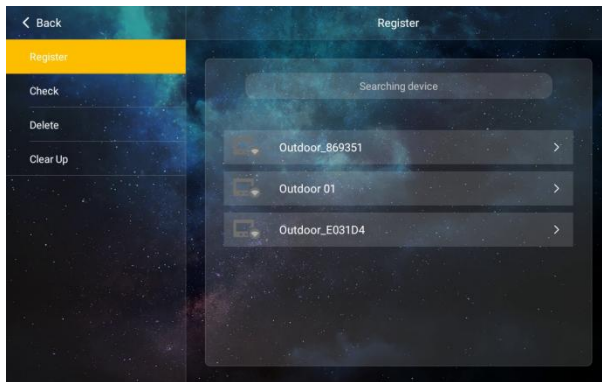

*Register Interface*

- Input card number or swipe card to register, and switch on the Card button to enable the anti-copy function, the card info will be encrypted and can not be copied.
- Input card number or swipe card to check if card is registered.
- Input card number or swipe card to delete the card.
- Select device to clear up the data of registered cards.

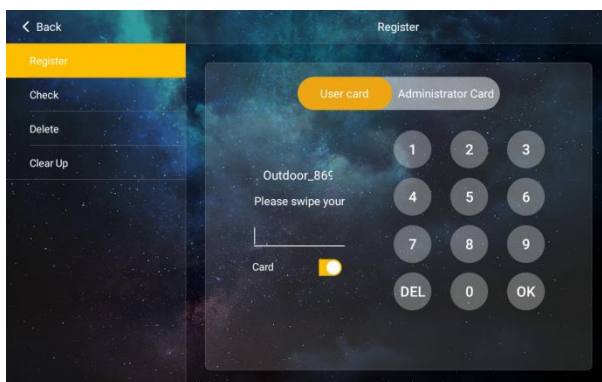

*Registering Card Interface*



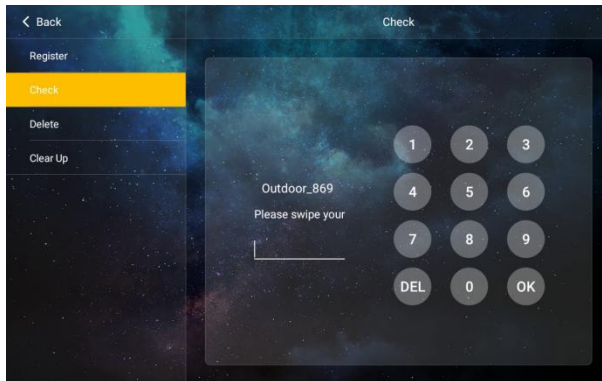

*Check Card Interface*

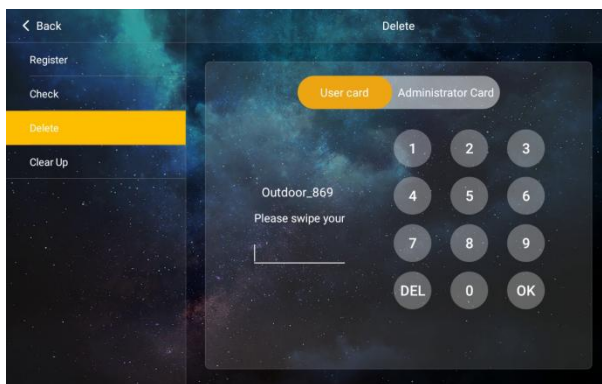

*Delete user card Interface*

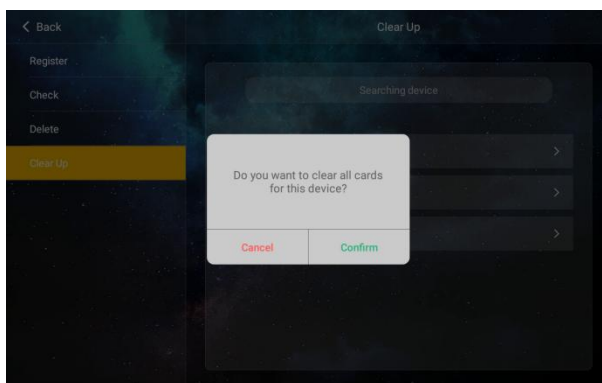

*Clear up Interface*

# Chapter 4 System Settings

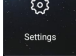
In the main interface to click  to enter the interface of System Settings,as shown below. System Systems includes Display Setting, Sound Setting, Time Setting, Language Setting, Call Forwarding, Password Setting, Engineering Setting and About.Clicking each Setting label can enter their next directory.

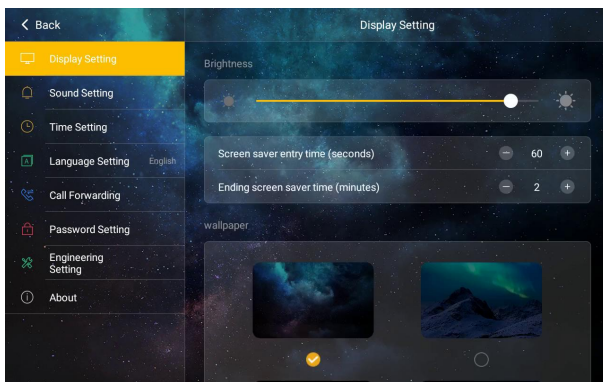

*System Settings Interface*

## 4.1 Display Setting

Operation path: Settings > Display Setting

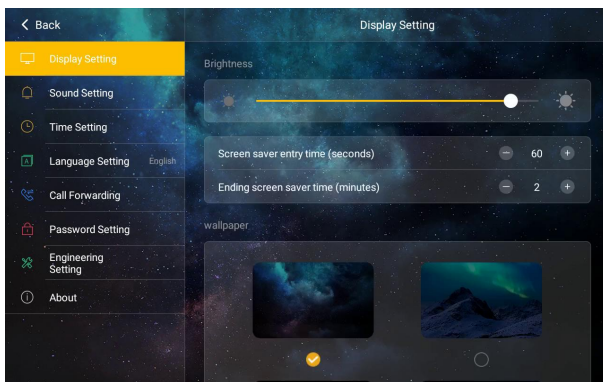

*Display Setting Interface*

## Parameter Setting

- Brightness: brightness is adjustable, by default the brightness is maximum.
- Screen saver entry time: the time to enter screen saver is adjustable, range from 30s to 255s.
- Ending screen saver time: the time to end screen saver is adjustable, range from 1min to 10mins.

Wallpaper for screen saver: By default there are four wallpapers, users can import customized wallpaper by using PC configuration tool.

## 4.2 Ringtone Setting

Operation path: Settings > Sound Setting

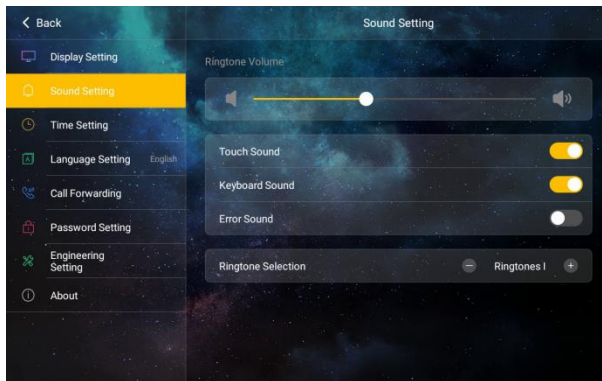

*Sound Setting Interface*

## Parameter Setting

- Ringtone Volume: It's adjustable.
- Touch Sound: Can be enabled and disabled.
- Keyboard Sound: Can be enabled and disabled.
- Error Sound: Can be enabled and disabled.
- Ringtone Selection: By default 5 types of ringtone are selectable.

## 4.3 Time Setting

Operation path: Settings > Time Setting

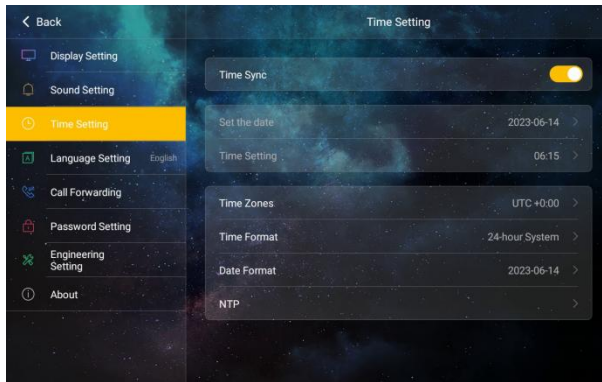

*Time Setting Interface*

### Parameter Setting:

- Time Sync: By default it's enabled. After selected the Time Zone, NTP server will auto sync time to the device. If disable Time Sync, user will manually set the date and time.
- Time Zones: User can select the specific time zone, by default time zone is set as UTC +0:00;
- Time Format: Can be 12-hour system or 24-hour system;
- Date Format: Select the date format as required. Optional date format: Year-Month-Day; Day-Month-Year; Month-Day-Year.
- NTP Server: Input NTP server address, by default provide three NTP Servers.

## 4.4 Language Setting

Operation path: Settings > Language Setting



*language setting Interface*

Can select 8 languages including English, Italian, Spanish, French, German, Hebrew, Simplified Chinese and Traditional Chinese.

## 4.5 Call Forwarding

Operation path: Settings > Call Forwarding

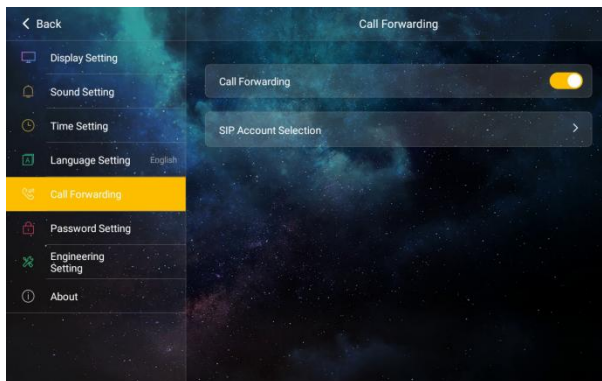

*Call Forwarding Interface*

On the address book of SIP Account Selection to select the object of accepting call forwarding, only one contact can be selected.

# 4.6 User Password Setting

Operation Path: Settings > User Password Setting

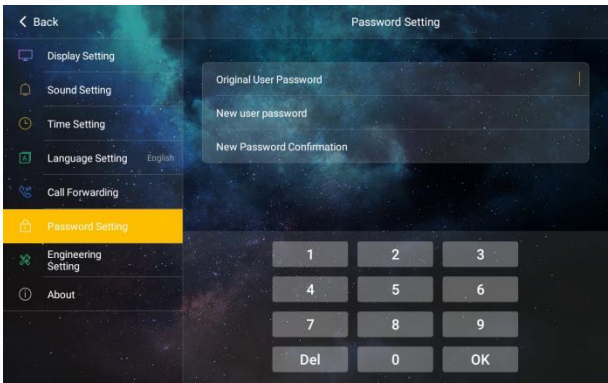

User Password Setting Interface

User password can be modified, by default the user password is 666666.

# 4.7 About

Operation path: Settings > About

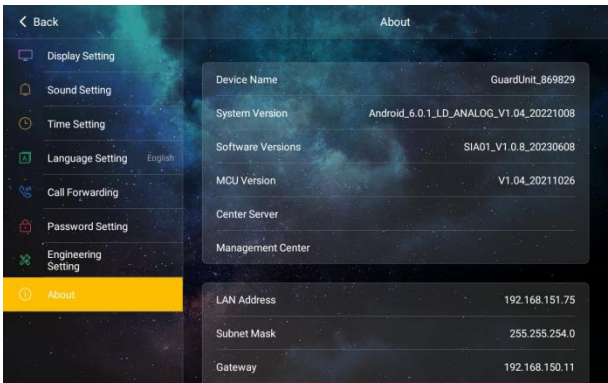

About Interface 1

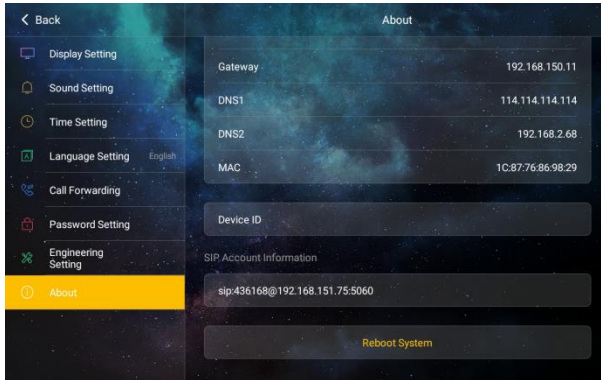

### *About Interface 2*

- Device Name, System Version, Software Version, MCU Version, Center Server, Management Server
- Ethernet Info (LAN, Subnet, Gateway)
- WIFI Info (WLAN, Subnet, Gateway)
- Device ID (A unique identifier for the device)
- SIP Account info of Device (SIP Account of the Device, SIP Account 1, SIP Account 2, Cloud SIP Account.)
- Reboot System: Click this label to restart the device.

# 4.8 Engineering Setting

Operation path: Settings > Engineering Setting

Input the Engineering Password 801801 to enter the interface: Device Name, SIP Account Setting, Network Setting, Cell ID configuration, Cloud Server Settings, One Click Unlock Setting, Password Authentication, Reset User Password Setting.

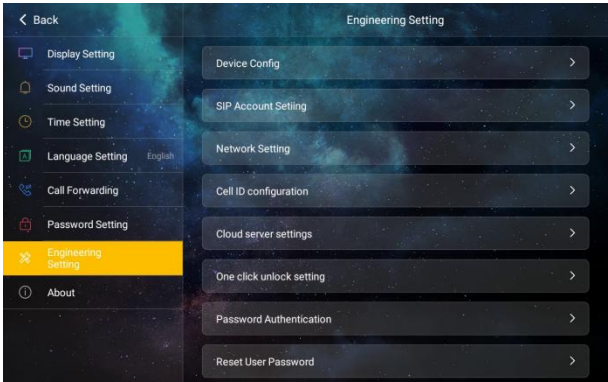

Engineering Setting Interface

## 4.8.1 Device Name

Operation path: Settings > Engineering Setting > Device Name

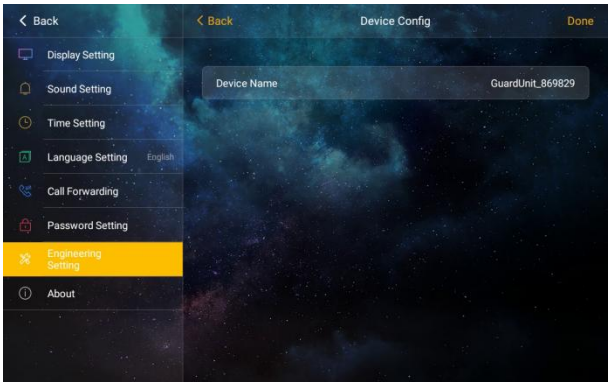

Device Name Setting Interface

### Parameter Setting

Device Name: Device Name can be modified. If you need the SIP account info from the



address book, you are required to set the device name to be the one corresponding to the account information in the address book, then it will pop up a tips window to let user to decide if to use the account info or not.

### 4.8.2 SIP Account Setting

Operation path: Settings > Engineering Setting > SIP Account Setting

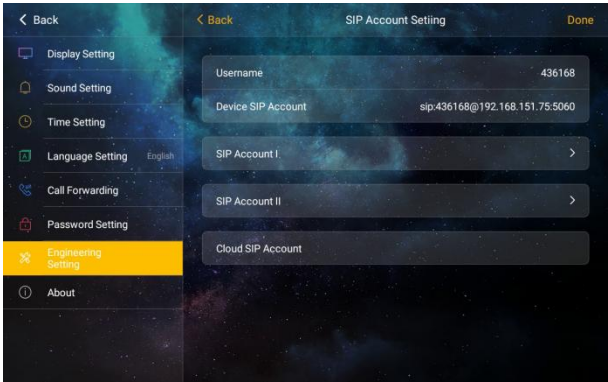

SIP Account Setting Interface 1

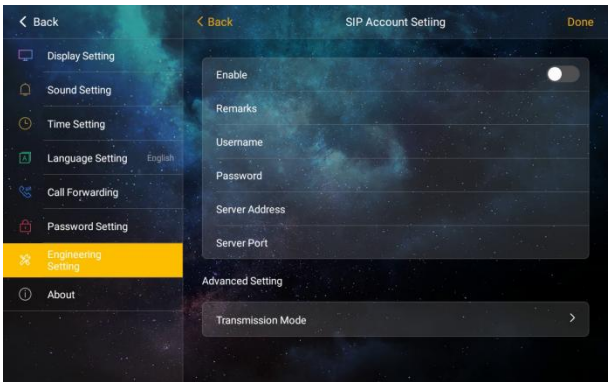

SIP Account Setting Interface 2

- Username: User can call to the Guard Unit by entering the username through the dial keyboard, the username can not be the same as others under the same network.
- Local SIP Account of the Device: The username and IP address of the device can

generate local SIP Account that's used as the account being called under the same network.

- SIP Account 1&2: User can manually configure SIP account info. Switch on the Enable button, then input username, password, Server address, Server port and select the Transmission Mode. User can also use the account info of address book by configuring device name.
- Cloud SIP Account: After device connected to Cloud Server, The Cloud Server will assign a Cloud Intercom SIP account to the device, to help the device achieve Cloud Intercom function.

### 4.8.3 Network Setting

Operation path: Settings > Engineering Setting > Network Setting

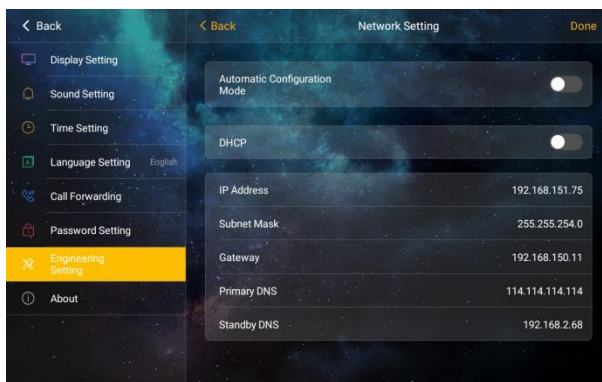

*Network Setting Interface*

#### Parameter Setting:

- Automatic Configuration Mode: After enabled this mode, the device can find all the other S series devices that are under the same network.
- DHCP: By default it's enabled, if disabled DHCP, it's required to manually input the IP address, Subnet mask, Gateway and DNS.

#### 4.8.4 Cell ID Configuration

Operation path: Settings > Engineering Setting > Cell ID Configuration

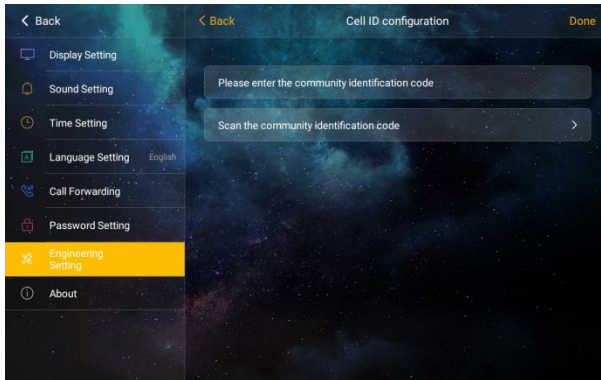

*Cell ID Configuration Interface*

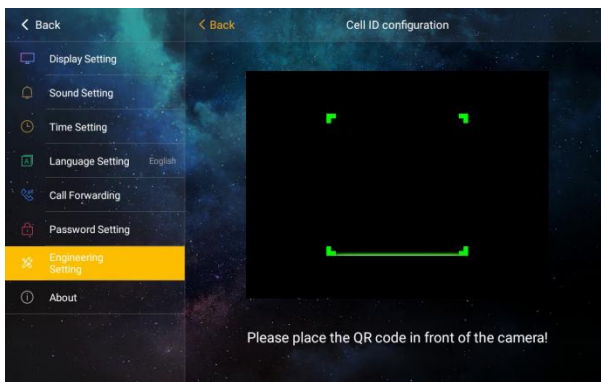

*Scanning QR Code Interface*

Input the Cell ID or scan the QR code of Cell ID, to bind the device with the community(Cell).

#### 4.8.5 Cloud Server Settings.

Operation path: Settings > Engineering Setting > Cloud Server Settings

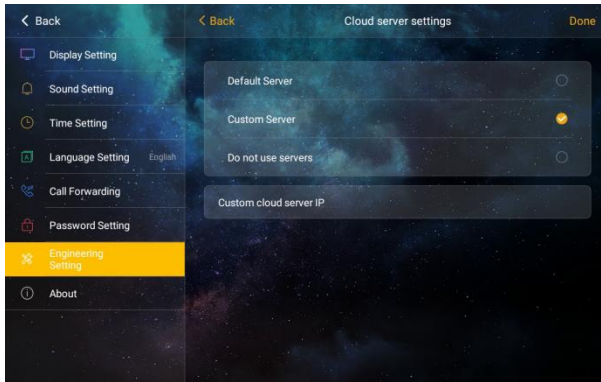

*Cloud Server Settings Interface*

Cloud Server Setting is set as Default Server by default; Custom Server is required user to input the address of server manually; NO server is equal to shut down the server.

#### 4.8.6 One Click Unlock Setting

Operation path: Settings > Engineering Setting > One Click Unlock Setting

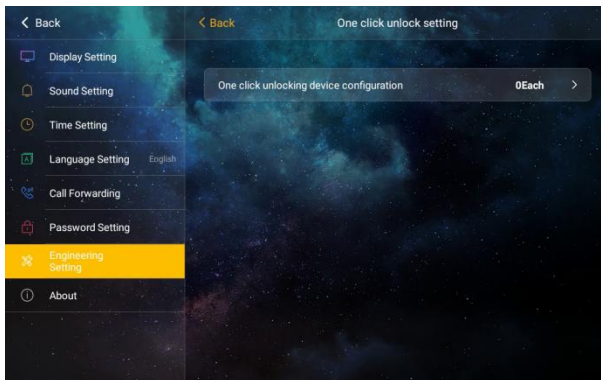

*One Click Unlock Setting Interface*

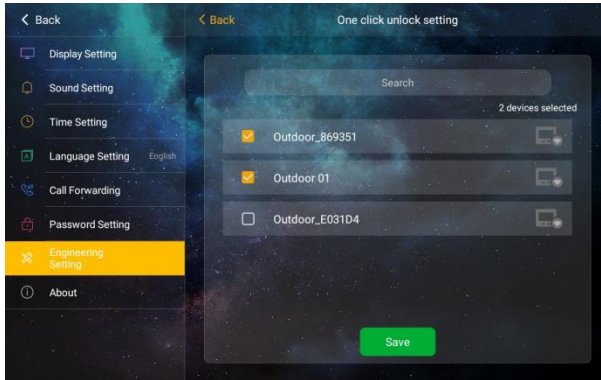

*Select One-click-Unlock-Setting Interface*

In the list to select which devices that can be unlocked by One Click Unlock function.

## 4.8.7 Password Authentication

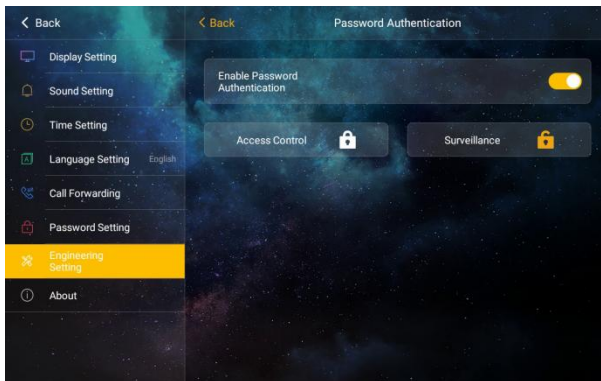

*Password Authentication Interface*

After enabled the Password Authentication, encrypt the functions needed, it will be required to input user password for using these functions.

#### 4.8.8 Reset User Password

Operation path: Settings > Engineering Setting > Reset User Password

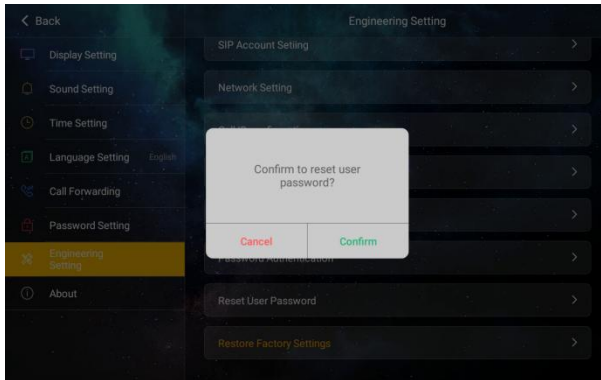

*Resetting User Password Interface*

Once user forgot the user password, user can reset the user password to be 666666.

#### 4.8.9 Restore Factory Setting

Operation path: Settings > Engineering Setting > Restore Factory Setting

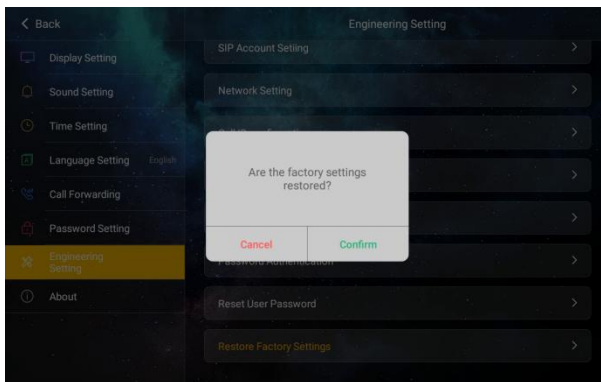

*Restore Factory Setting Interface*

- After 60 seconds after powering on, to restore the factory settings, then the device will be reset to defaulted parameter.
- Within 60s after powering on, to restore the factory settings, then the device will be reset to defaulted parameter, meanwhile all the record will be cleared up.